

# EagleMax Series 201 Saw Gin

Continental Eagle



EagleMax 201 Gin Stand and 9120 Feeder



Seed Roll Tube  
& Conveyor



Picker Roller

## The EagleMax Series 201 Saw Gin

*....can produce high quality lint at proven rates of 25 bales per hour.*

- Continental Eagle designed ginning system equipped with the exclusive high capacity Seed Roll Conveyor Tube.
- A forward-tilting ginning breast allows convenient inspection of the ginning ribs, roll box and optional huller ribs.
- Placement of the new designed picker roller eliminates force-feeding the gin saws.
- Huller front tilts forward for accessibility to the picker roller and the roll box. The seed roll can be easily dumped.
- 201 gin frame is equipped with a rib rail for the addition of huller ribs if cotton conditions or customer warrants their use.
- Compact overall gin design, featuring rigid-weld steel construction.
- Segmented heads for easy front removal of gin saw and gin brush.
- Optional open-end huller ribs.

**EAGLEMAX 201**



# EagleMax Series 201 Saw Gin Continental Eagle

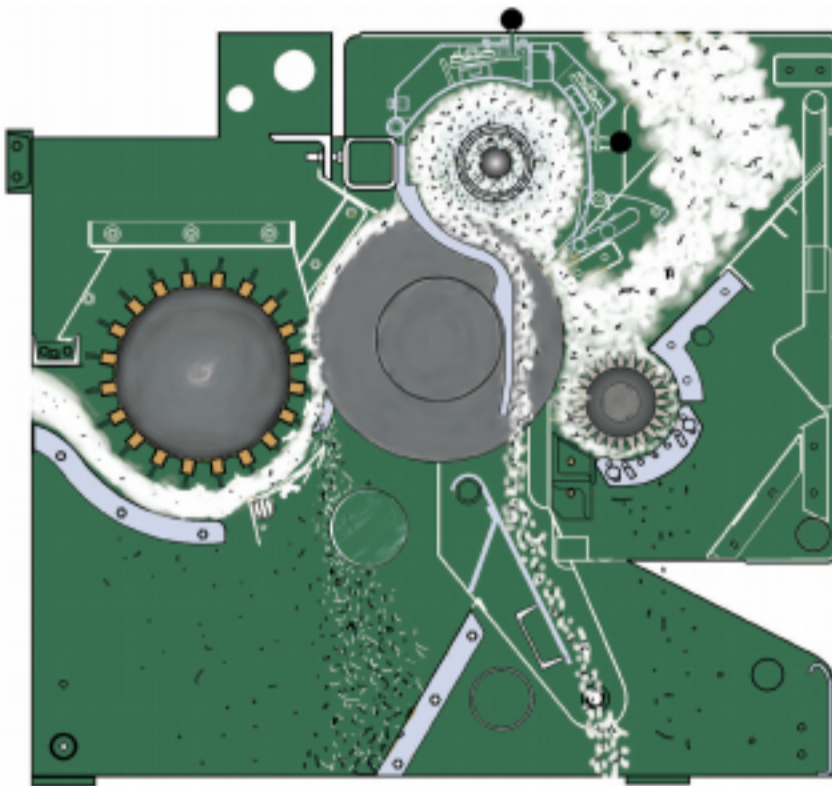

## The EagleMax Series 201 Saw Gin

*...can produce high quality lint at proven rates of 25 bales per hour.*

**Stainless Steel Roll Box** - Featuring self-forming seed roll, uniform saw tooth loading, high-capacity seed discharge and automatic feed.

**Seed Roll Conveyor Tube** - (removes ginned seed from the center of the seed roll.) This exclusive 5" (127mm) diameter louvered design rapidly removes seed. Speed of rotation is coordinated with the natural rotation of the seed roll for effective, positive results. Sealed bearings throughout.

**Top Mounted Ginning Ribs with Inserts** - Engineered for safety and high performance, featuring super-strength at the ginning point. Cantilever rib design for tag relief.

**16" Gin Saws** - Featuring scientifically designed and heat tempered saw teeth. The design creates less friction at the ginning point. Saws are of standard gauge and are precision ground, mounted on a 6 7/8" (174.6 mm) diameter Saw Shaft with 4 7/16" (112.7 mm) Pillow Block Bearings.

**Brush & Saw Removal** - Segmented heads for easy front removal of gin saw and gin brush.

## Flow Of Cotton

Lint is pulled and separated from the cotton seed by the gin saw rotating between ginning ribs. The saw teeth carry the lint through the evenly spaced ginning ribs at the ginning point and the seed is left behind in the roll box. The saw consists of 201 saw blades mounted on a journal that rotates at 615 RPM. The saw blades have 330-teeth and are 16 inches (406mm) in diameter. Approximately 50 percent of the seed passes through holes in the seed tube located in the center of the roll box where they are conveyed to the ends of the gin and discharged to the seed conveyor below the gin. The remaining seed is purged from the bottom of the seed roll and falls into the seed conveyor. Lint is removed from the saw by the doffing brush.

**Positive Brush Doffing** - Lint is removed directly from the gin saws at super-capacities producing a smooth sample. Features positive lint discharge and adjustable air intake.

**Lower Moting** - Adjustable mote board allows for additional cleaning.

**Optional Huller Ribs** - Gin Frame supplied with rib rail for optional huller rib use.

## Technical Specifications

**Capacity**..... 25 bales plus per hour  
**Saw** .....16" (406mm) dia 201 saw blades, 615 rpm  
**Doffing Brush**..15" (381mm) dia. 20 rows of brushes, 1552rpm  
**Seed Roll Tube**..... independent drive 5" (127mm) steel tube rotates at 270 rpm, 4" (101.6mm) conveyor rotates at 854 rpm  
**Gin Motor**.....(not included with machine) 250 hp  
**Picker Roller**.....independent drive 350 rpm

## Dimensions

**Length** (front, with covers).....(4470 mm) 176"  
**Height** (front to bottom of feeder).....(1343 mm) 52 7/8"  
**Width** (with covers) .....(2383 mm) 93 13/16"  
**Saw Shaft** centerline to floor .....(730 mm) 28 3/4"  
**Weight** (approximate) .....(3628 kg) 8000 lb

Manufactured and Marketed by



**BAJAJ STEEL INDUSTRIES LIMITED**

IMAMBADA ROAD, NAGPUR- 440 018. INDIA  
 Tel: +91-712-272 0071 ~ 80 Fax: +91-712-272 8050 / 272 3068  
 email : [cecsales@bajajngp.com](mailto:cecsales@bajajngp.com) / [bsi@bajajngp.com](mailto:bsi@bajajngp.com)  
 website : [www.bajajngp.com](http://www.bajajngp.com)



Telephone: (334) 365-8811 • Fax: (334) 361-7627  
 Web Site: [www.coneagle.com](http://www.coneagle.com)